

Lifts the floor from cold, damp concrete and allows the concrete to breathe

ProVa-Flor Subfloor System

Lifts The Floor Off Damp, Cold Concrete And Allows The Concrete To Breathe

SEAMLESS HDPE barrier protects floor coverings from slab moisture. It's like having an "above grade" floor!

Step 1

- Remove existing floor coverings
- Level low areas if required
- Clear debris



Step 2

- Unroll first strip of ProVa-Flor
- Cut to length
- Cut off smooth tab



Step 3

- Install second strip of ProVa-Flor
- Smooth tab overlaps 2 rows of dimples on adjacent strip
- Tape seam with "housewrap" tape



Step 4A

- Laminate underpad and flooring is installed directly over ProVa-Flor
- Outperforms "damp-proof" underpad
- Follow Laminate manufacturers instructions



Step 4B

- Other floor coverings require a "load spreading sheet" or subfloor (Minimum 5/8" butt-edge or tongue & groove (T&G) plywood or OSB sheets)
- Fit and lay the subfloor panels on the ProVa-Flor
- Fasten to the concrete around room perimeter
- Also fasten where there is vertical movement

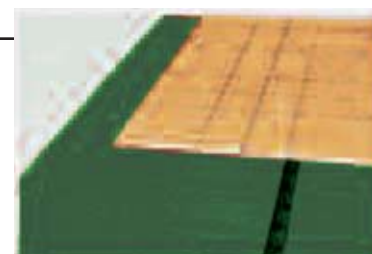

NOTES:

- Fasten with concrete screws
- Non load bearing walls may be framed on the subfloor
- Install your choice of floor covering following manufacturers "above grade" instructions



ProVa-Flor Subfloor System

Installation Procedures

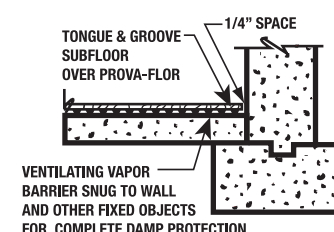

ProVa-Flor is a strong, tough 24-mil HDPE membrane with a unique double dimple design that provides exceptional compressive strength with minimum deflection. By using ProVa-Flor over concrete, an impermeable vapour barrier and air gap is created. This allows damp concrete to breathe while keeping the floor dry. Warmer in winter, dry and odor free in humid summer weather. ProVa-Flor is the SOLUTION for problems associated with flooring over concrete. On fresh concrete, you can install flooring as soon as you can walk on the slab.

FLOATING FLOORS:

In homes, laminate flooring may be placed directly over ProVa-Flor as a "floating floor" with landscape fabric (used for weed control) under the ProVa-Flor to prevent noise and thin foam laminate underpad over the ProVa-Flor. (Commercial use and heavy point loads such as slate billiard tables, install laminate over a minimum 5/8" "secured subfloor")

SECURED SUBFLOORS:

For other floor finishes, plywood or OSB sheets (Minimum 5/8" butt-edge or tongue & groove (T&G) plywood or OSB sheets) are laid as a subfloor over the ProVa-Flor and fastened to the concrete floor - 24" grid spacing.

HINT: Fasten with concrete screws. Pilot hole required. Top of concrete screw to be flush with plywood.

1. Remove existing floor coverings. Ensure the concrete is clear of debris. Level low areas with floor leveling compound if required. Cover the concrete with landscape fabric only if the floor is to be "floating"
2. Roll out the first strip of ProVa-Flor, dimples toward the floor, flat tab away from the wall and cut to length. Cut off the flat tab. "Reverse roll" the ProVa-Flor if it curls excessively.
3. Unroll the next section with the flat tab overlapping the first section and cut to length. At "end of roll" joints mesh 4 rows of dimples, caulk and tape. Seams must be sealed using butyl rubber caulking, foam panel adhesive or house wrap poly tape.

4. Cover the ProVa-Flor with either butt-edge or tongue & groove (T&G) plywood or OSB sheets (5/8" minimum). Fasten through the subfloor and ProVa-Flor 1" into the concrete and a 24" grid and/or where there is vertical movement. The 4" joints between adjacent 4x8 sheets should be strapped. Leave 1/4" clearance around the perimeter of the subfloor to allow for expansion. Non load bearing walls may now be framed on the subfloor.

Install your choice of flooring, following the floor manufacturers installation recommendation. Additional instructions to ProVa-Flor subfloor installations are. Vinyl floor: Glue and staple 1/4" underlay (as recommended by the flooring manufacturer) over the second subfloor, stagger the joints between the underlay and the subfloor.

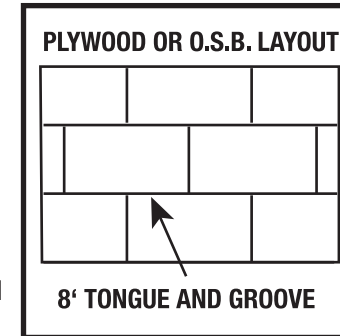

Hardwood: if the flooring is to be nailed down, used 3/4" OSB and short nails or 2 layers of subflooring (totaling 1" or more) so as not to puncture the ProVa-Flor.

Laminate flooring: may be installed directly over ProVa-Flor as a "floating" floor. The concrete floor must be level. Place landscape fabric on the concrete under ProVa-Flor (to prevent noise), the laminate manufacturers recommended underpad over the ProVa-Flor and then install the laminate. For Commercial use and heavy point loads such as slate billiard tables, install laminate over a minimum 5/8" "secured subfloor" (Landscape fabric is not required under a secured floor). Carpet: Install over a minimum 5/8" subfloor fastened with a 24" grid pattern.

All information provided herein is intended to be used as a guide only. No recommendations are to be interpreted as superseding or replacing any installation recommendations of the flooring manufacturer. No warranty on the performance of the floor covering is given or implied.

Technical Data:
ProVa-Flor Roll size 44.5" X 50' (185 sq ft roll)
Maximum Sheet Thickness: -24mil in the flat sections, 21 mil in the dimples.
Dimple Height: 3/8" (10 mm)
Compressive Strength: (75% deflection) 7,800 lb/sq.ft. / 376 kN/m²
Working Temperature: -58°F to +176°F / -50°C to +80°C
Softening Temperature: +257°F / +125°C
Thermal Resistance: R .68
Water Vapour Permeability: 1.5x10.3 g/m²h. /10x>builders poly

Air Volume/Dimple Side: 1 gal/yd² / 4.0LYm²
UV Stabilization: Minimum 2% carbon black content
Toxicity: None (ProVa-Flor is chemically inert and 100% environment friendly)
Life Expectancy: Greater than 30 years (Average residential floor loading of 80lb/sq.ft at temperature less than 102°F / 39°C, 50% deflection)

